

# 2024 Inaugural Australasian Neurogastroenterology and Motility Masterclass

**Translational Research Institute**  
*Brisbane, Queensland, Australia*

# 2024 ANMM

Friday 01 - Saturday 02 March 2024

**Co - Convenors**

Prof Gerald Holtmann, QLD

Prof Nicholas Talley, NSW

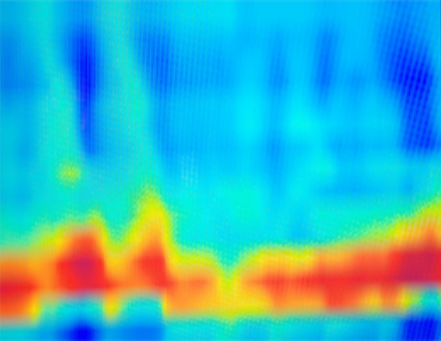

# 2024 Inaugural Australasian Neurogastroenterology and Motility Masterclass



Translational Research Institute  
Brisbane, Queensland, Australia



Friday 01 - Saturday 02  
MARCH 2024



## International Faculty

Prof Uday Ghoshal, Apollo Multispeciality Hospitals, Kolkata, India

Prof Kok-Ann Gwee, National University Singapore, Singapore

Prof Purna Kashyap, Mayo Clinic, Rochester, MN, USA

A/Prof Jutta Keller, University of Hamburg, Germany

Prof Justin Lee, Universiti Sains Malaysia, Kota Bharu, Malaysia

Prof Richard McCallum, El Paso, Texas Tech University, USA

Prof Greg O'Grady, University of Auckland, NZ

Prof Kewin Siah, National University Singapore, Singapore

Prof Vincenzo Stanghellini, University of Bologna, Italy

## National Faculty

Prof Alex Boussioutas, VIC

A/Prof Rebecca Burgell, VIC

Prof Phil Dinning, SA

Prof Uwe Dulleck, ACT

Dr Kerith Duncanson, NSW

Dr Emma Finch, QLD

Prof Peter Gibson, VIC

Dr Chris Gillispie, QLD

A/Prof Magnus Halland, NSW

Prof Gerald Holtmann, QLD

Prof Michael Horowitz, SA

Prof Mike Jones, NSW

Prof Michael Kamm, VIC

Prof Simon Keely, NSW

A/Prof Lutz Krause

Prof Antonina Mikocka-Walus, VIC

Prof Mark Morrison, QLD

Dr Jenny Myers, SA

Ms Lauren Schooth, QLD

Dr Ayesha Shah, QLD

Prof Nicholas Talley, NSW

Prof Nikhil Thapar, QLD

# Floorplan

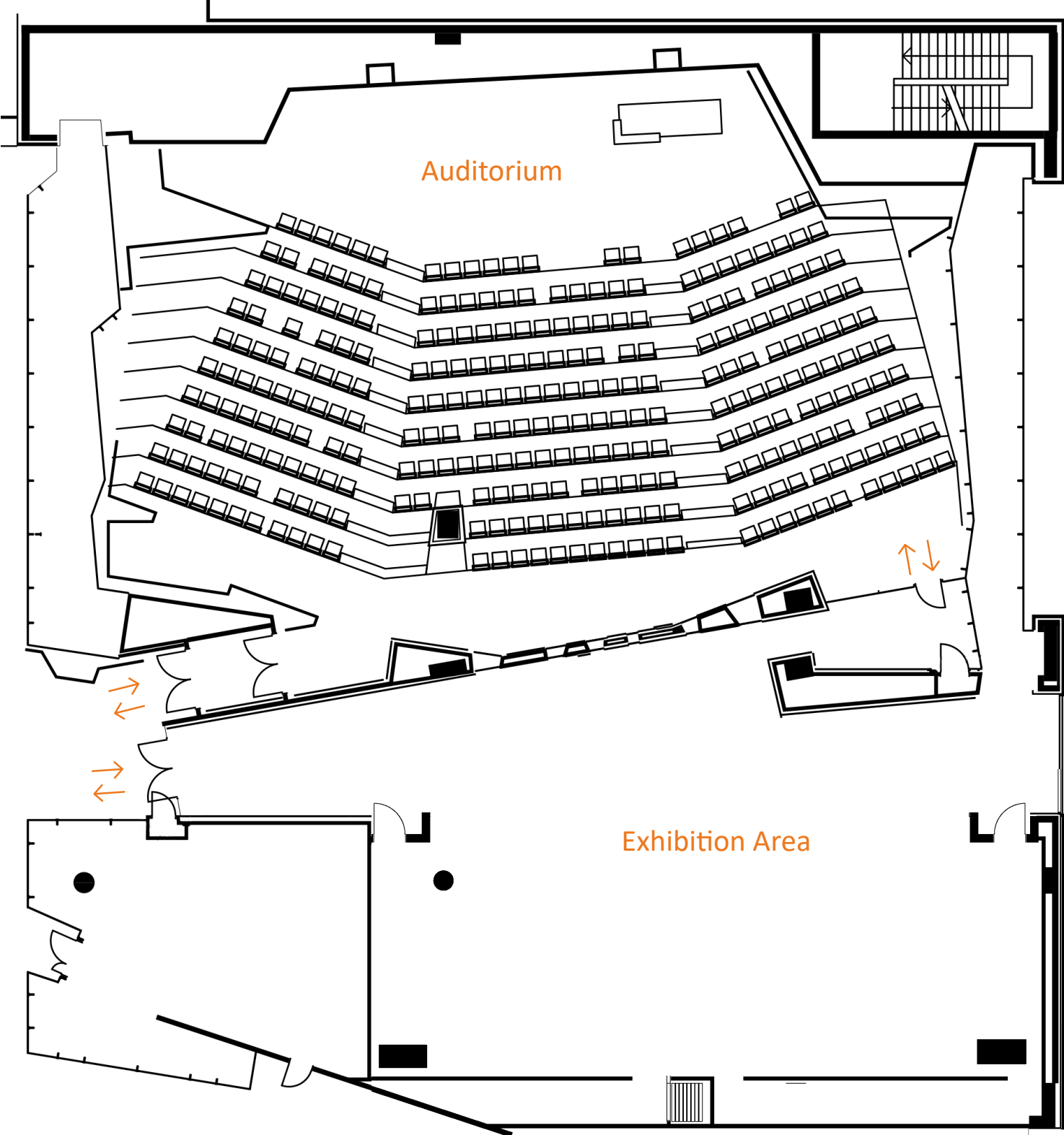

# Friday 01 March

0900 Welcome  
**Gerald Holtmann**

## Scientific Session 1 CONCEPTS AND PARADIGMS Chairpersons | Peter Gibson, Ayesha Shah

---

0910 1.1 What are Disorders of Gut Brain Interaction? Clinical Assessment and Approaches to diagnose?  
**Nicholas Talley**

0935 1.2 The Primary Care Perspective of DGBI: Clinical Presentation and Burden of Disease  
**Alireza Ahmadvand**

1000 1.3 Mucosal or systemic inflammation in DGBI - cause, consequence or innocent bystander?  
**Simon Keely**

1025 Q&A

1030 MORNING REFRESHMENTS | *Exhibition Area*

## Scientific Session 2 OESOPHAGUS AND TRAINING Chairpersons | Nicholas Talley, Jenny Myers

---

1100 2.1 Approach to the patients with oropharyngeal dysphagia: the speech pathologists view  
**Emma Finch**

1120 2.2 High resolution Manometry: tips and tricks  
**Jenny Myers**

1140 2.3 Differential diagnosis for altered oesophageal motility  
**Uday Ghoshal**

1200 2.4 How to ensure that the next generation of clinicians provides the services our communities need in relation to DGBI?  
**Alex Boussioutas**

1220 Q&A

1230 LUNCH | *Exhibition Area*

### Scientific Session 3

#### FUNCTION AND DISORDERS OF THE GASTRODUODENAL REGION

Chairpersons | Justin Lee, Mike Jones

---

- 1330 3.1 Approach to the patient with nausea, vomiting and suspected gastroparesis  
**Richard McCallum**
- 1350 3.2 New insights into duodenal microbiota in DGBI  
**Lauren Schooth**
- 1410 3.3 Electric mapping and gastric motor function: past, present and future  
**Greg O'Grady**
- 1430 3.4 Gastric Motility Disorders in Patients with Diabetes  
**Michael Horowitz**
- 1450 Q&A
- 1500 AFTERNOON REFRESHMENTS | *Exhibition Area*

### Scientific Session 4

#### DISORDERS OF THE SMALL INTESTINE

Chairpersons | Peter Gibson, Grace Burns

---

- 1530 4.1 The small intestine as the microbiologists new terra incognita  
**Mark Morrison**
- 1550 4.2 Small intestinal dysbiosis and DGBI: past, present and future  
**Ayesha Shah**
- 1610 4.3 Intestinal pseudo-obstruction  
**Nikhil Thapar**
- 1630 Q&A

# Friday 01 March

## Scientific Session 5

### SUNSET SESSION: COMPLEMENTARY THERAPIES Chairpersons | Gerald Holtmann, Kok-Ann Gwee

---

- 1700 5.1 The Journey from Ancient Herbal Remedies to Evidence-Based Herbal Medicines for DGBI  
**Vincenzo Stanghellini**
- 1720 5.2 Herbal Medicines for DGBI: Any Added Value to Established Pharmacotherapies?  
**Kewin Siah**
- 1740 Q&A, Panel Discussion
- 1800 WELCOME RECEPTION

# Saturday 02 March

## Breakfast Sessions 0815 - 0930

---

- 0815 B.1 What can Epidemiology teach us about DGBI?  
**Mike Jones**
- 0845 B.2 Ambulatory Reflux Monitoring: Case-Based Discussion  
**Jenny Myers**

## Scientific Session 6

### ENABLERS FOR RESEARCH AND CLINICAL PRACTICE Chairpersons | Kok-Ann Gwee, Mark Morrison

---

- 0945 6.1 Managing difficult DGBI with abdominal pain, bloating/  
distension  
**Justin Lee**
- 1005 6.2 The Gut-Brain Axis: translating the concept into clinical  
practice  
**Gerald Holtmann**

- 1025 6.3 Climate Change the emerging risk for DGBI  
**Nicholas Talley**
- 1045 6.4 Standardisation and quality assurance of function testing. A European perspective  
**Jutta Keller**
- 1105 Q&A
- 1115 MORNING REFRESHMENTS | *Exhibition Area*

## Scientific Session 7

### NON PHARMACOLOGIC INTERVENTIONS IN PATIENTS WITH DGBI Chairpersons | **Nikhil Thapar, Emily Hoedt**

---

- 1145 7.1 Targeted modulation of the GI microbiome: prebiotics, probiotics and faecal transplantation  
**Purna Kashyap**
- 1205 7.2 Non-FODMAP and FODMAP interventions in DGBI  
**Kerith Duncanson**
- 1225 7.3 Psychological interventions in DGBI  
**Antonina Mikocka-Walus**
- 1245 Q&A, Panel Discussion
- 1315 LUNCH | *Exhibition Area*

## Scientific Session 8

### COLORECTAL DISORDERS (Co-Sponsored by ANGMA) Chairpersons | **Michael Kamm, Kerith Duncanson**

---

- 1415 8.1 The Irritable bowel syndrome - a syndrome with many causes?  
**Kok-Ann Gwee**
- 1435 8.2 Diagnostic and therapeutic approach to the patient with defecation disorders and incontinence  
**Rebecca Burgell**
- 1455 8.3 Anorectal & Colonic Manometry: What I need to know?  
**Phil Dinning**
- 1515 8.4 The surgeons approach to functional rectal disorders  
**Chris Gillispie**
- 1535 Q&A
- 1545 AFTERNOON REFRESHMENTS | *Exhibition Area*

Saturday 02 March

Scientific Session 9

DRIVERS FOR CHANGE AND CHALLENGES OF THE  
ESTABLISHED LANDSCAPE IN DGBI

Chairpersons | Justin Lee, Uday Ghoshal

---

- 1615 9.1 Health economic evaluation of interventions for FGID/  
DGBI  
**Uwe Dulleck**
- 1635 9.2 Molecular techniques for microbiome assessment: ready  
for prime time  
**Lutz Krause**
- 1655 9.3 New toys and tools for diagnosing DGBI  
**Peter Gibson**
- The experts perspectives - Gastrointestinal functional  
testing in patients with DGBI:
- 1715 9.4 Upper gastrointestinal tract  
**Magnus Halland**
- 1730 9.5 Lower gastrointestinal tract  
**Michael Kamm**
- 1745 Closing Remarks  
**Nicholas Talley & Gerald Holtmann**



# 2024 Inaugural Australasian Neurogastroenterology and Motility Masterclass



Translational Research Institute  
Brisbane, Queensland, Australia



Friday 01 - Saturday 02  
MARCH 2024

## ANMM SPONSORS



Clinical Excellence  
Queensland



Queensland  
Government



**JGHF**  
Journal of Gastroenterology  
and Hepatology Foundation



**MICROBA™**

**LONCH 朗致**

**Medtronic**  
Engineering the extraordinary



NHMRC  
Centre of Research Excellence  
in Digestive Health



Supported by



GESA Certified Sponsors



# 2024 INAUGURAL AUSTRALASIAN NEUROGASTROENTEROLOGY AND MOTILITY MASTERCLASS

Conference Secretariat



[anmm@tayloredimages.com.au](mailto:anmm@tayloredimages.com.au)

+61 7 3366 2205

[www.tayloredimages.com.au](http://www.tayloredimages.com.au)

Suite T19, 477 Boundary Street, Spring Hill QLD 4060