

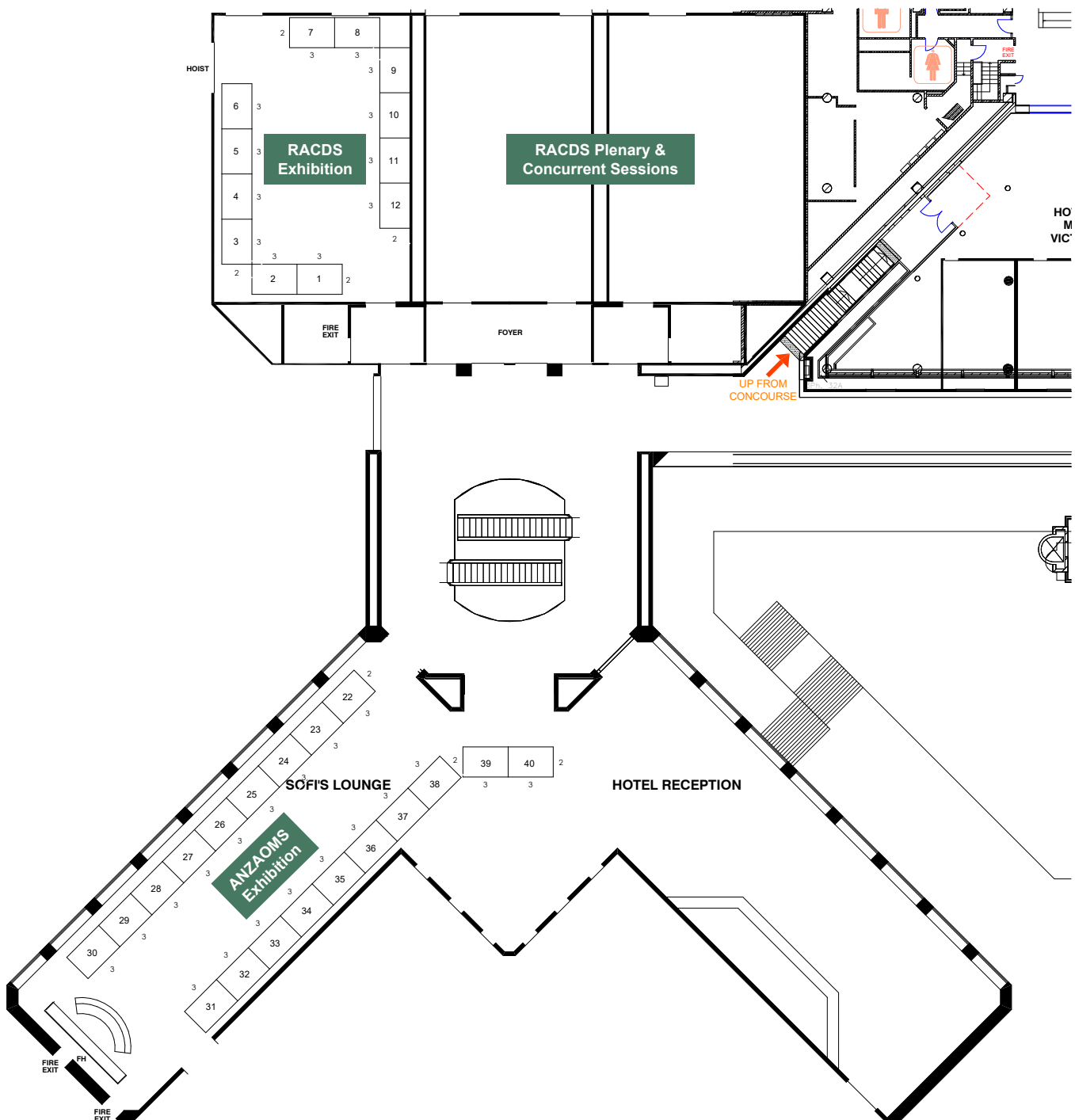

EXHIBITION FLOOR PLAN

The Fine Edge of Dentistry 2022 floorplan is included to help you select your preferred position.



Floor plan provided is indicative only at the time of publishing and is subject to change from time to time without notice.

Booth spaces will be allocated first to major sponsors, then to exhibiting companies on receipt of application and 50% deposit received. Entitlements will commence upon receipt of 50% deposit.