



2WALK&CYCLE CONFERENCE JULY 2018
INNOVATIVE SPACES

Team Velos

WSP-Opus & Aurecon

- Richard Landon-Lane (WSP-Opus)
- Design Manager
- Mitchell Cocking (Aurecon)
- Lead Designer

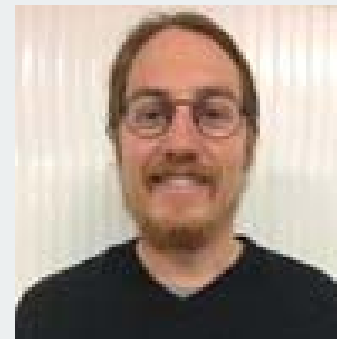

A cycleway is just green paint right?

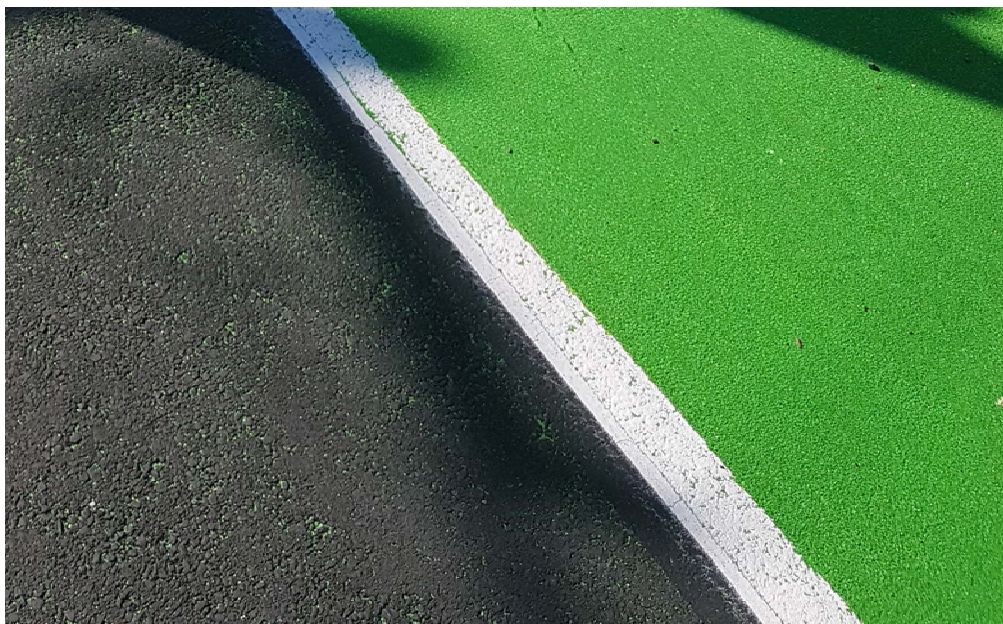



Design Considerations

Road Design
Street Lighting
Traffic Signals
Signage and Line-marking
Stormwater
Utilities (Water, Power, Comms, Fibre)
Consenting
Retaining Walls and Seawalls
Structures and Bridges
Ecology and Environment
Land Contamination

Landscaping
Heritage and Culture
Public Transport
Budget and Programme
Urban Design
Reserves and Parks
Wayfinding
Safety in Design
Vulnerable Users
Maintenance
Public and Stakeholders



Christchurch Major Cycle Routes (MCRs)

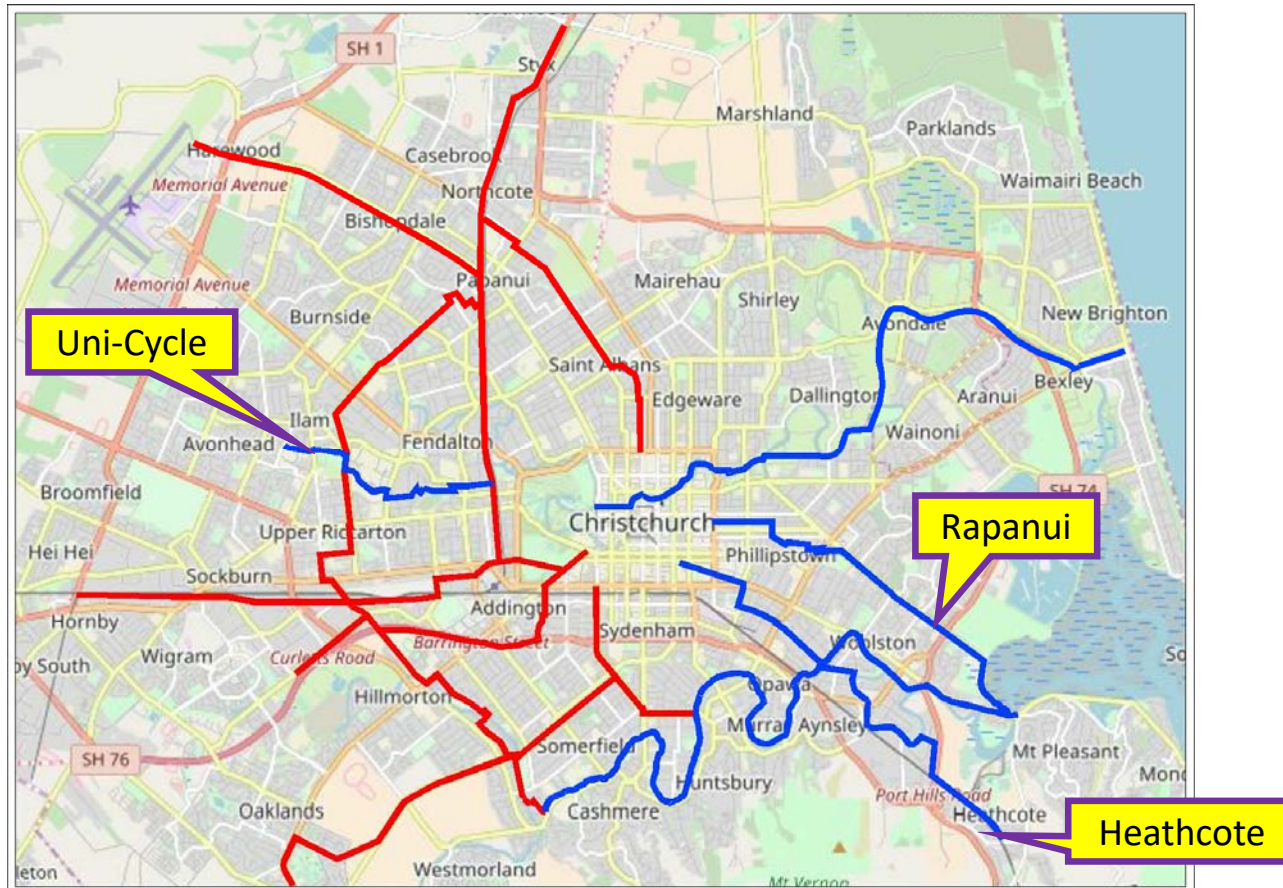



Rapanui (Shag Rock) Cycleway

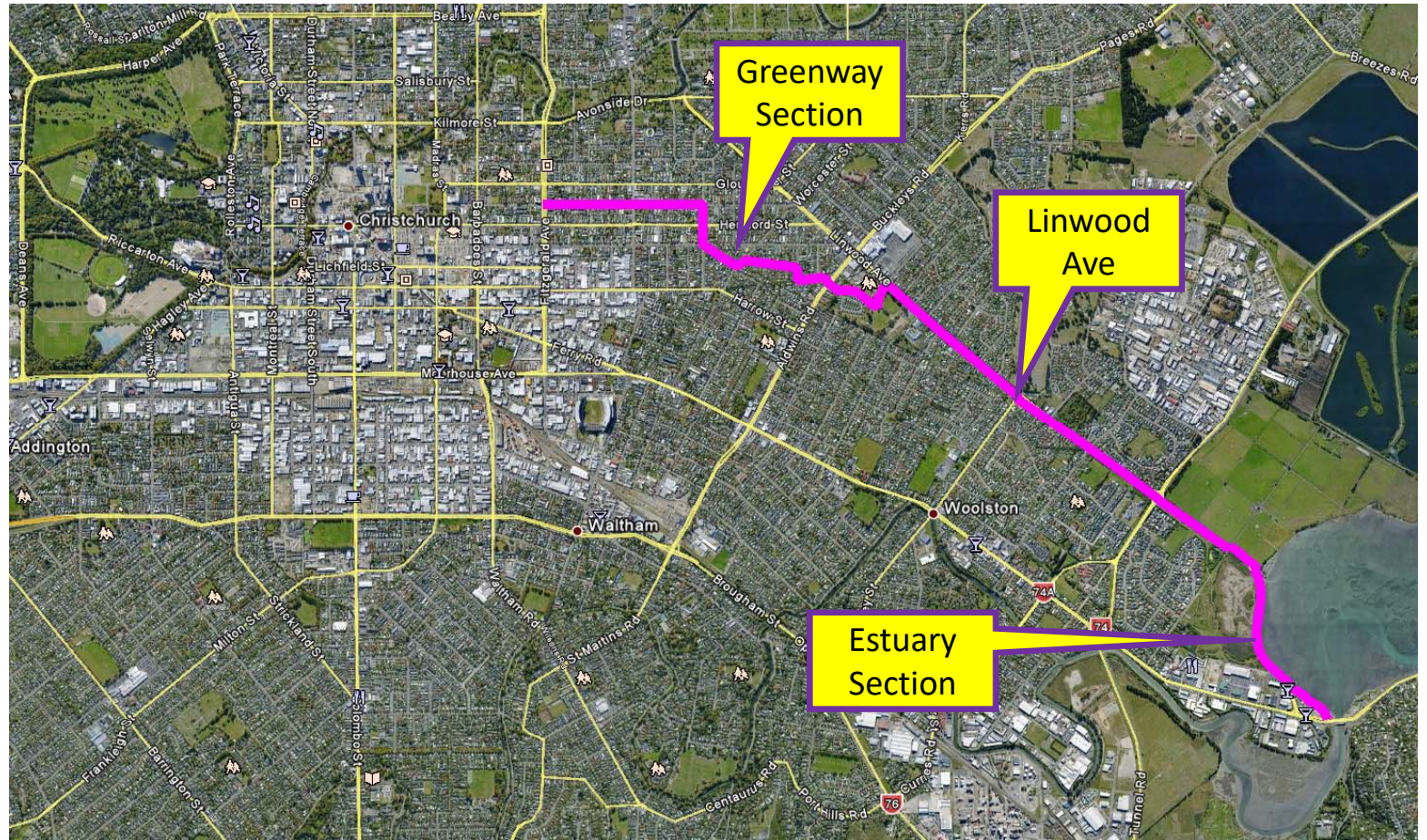



Rapanui (Shag Rock) Cycleway

Signalised Intersections (Arterial Roads)

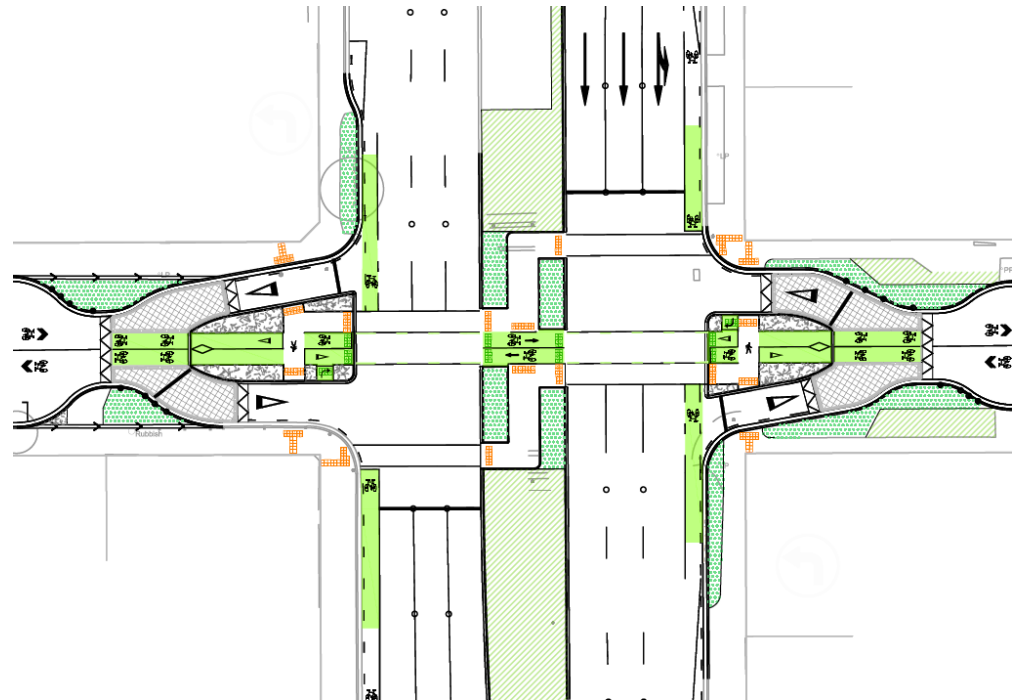



Rapanui (Shag Rock) Cycleway

Unsignalised Intersections (Minor Arterial/Collector Roads)

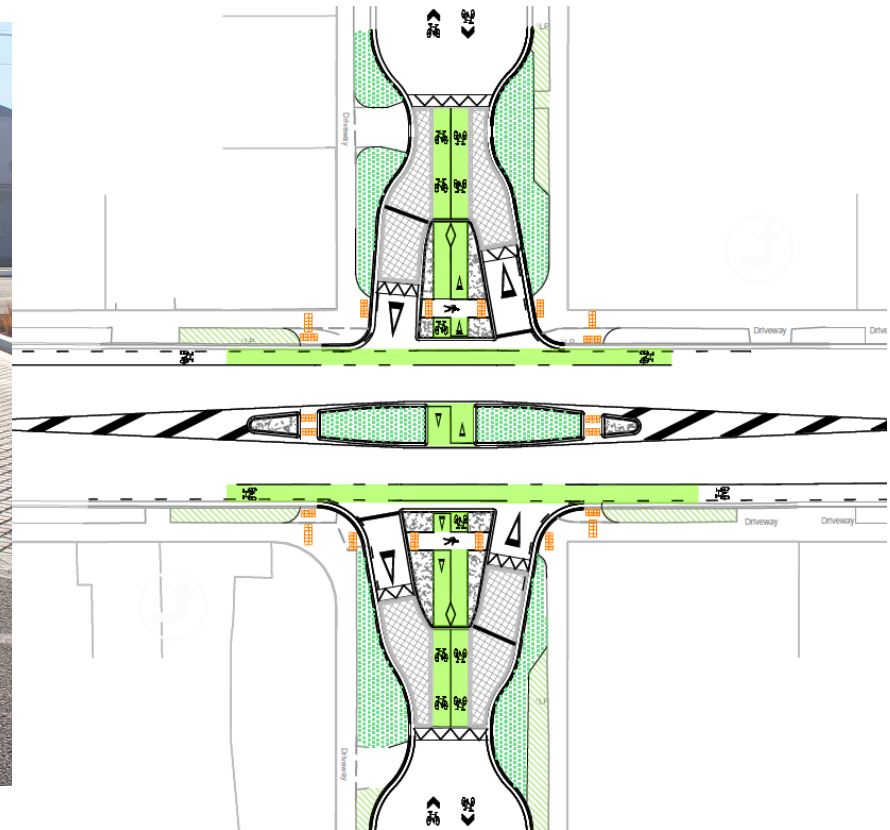



Rapanui (Shag Rock) Cycleway

Mid-block Treatment

- Narrowed carriageway
- 30km/hr posted speed
- Parking removal

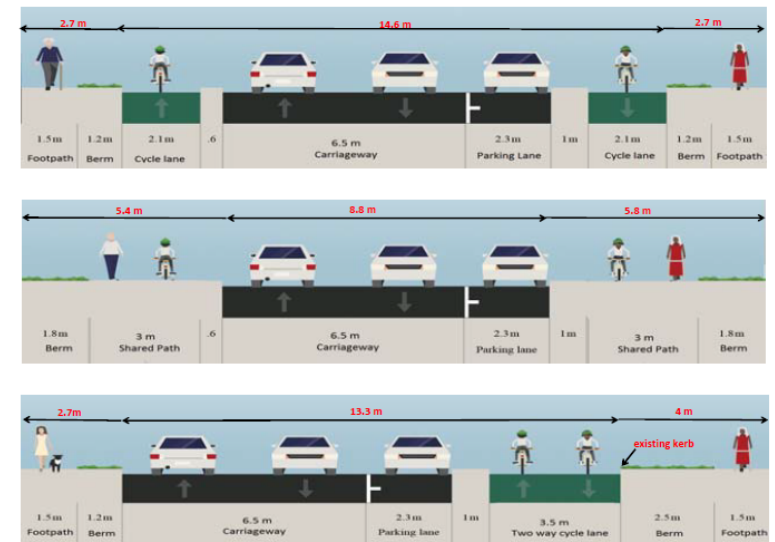
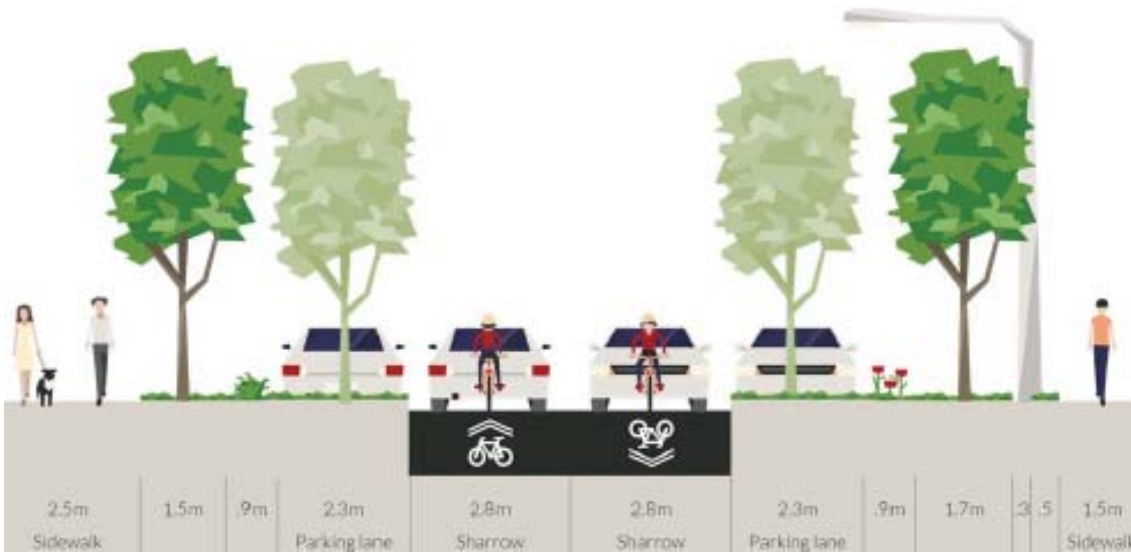



Rapanui (Shag Rock) Cycleway

Traffic Calming

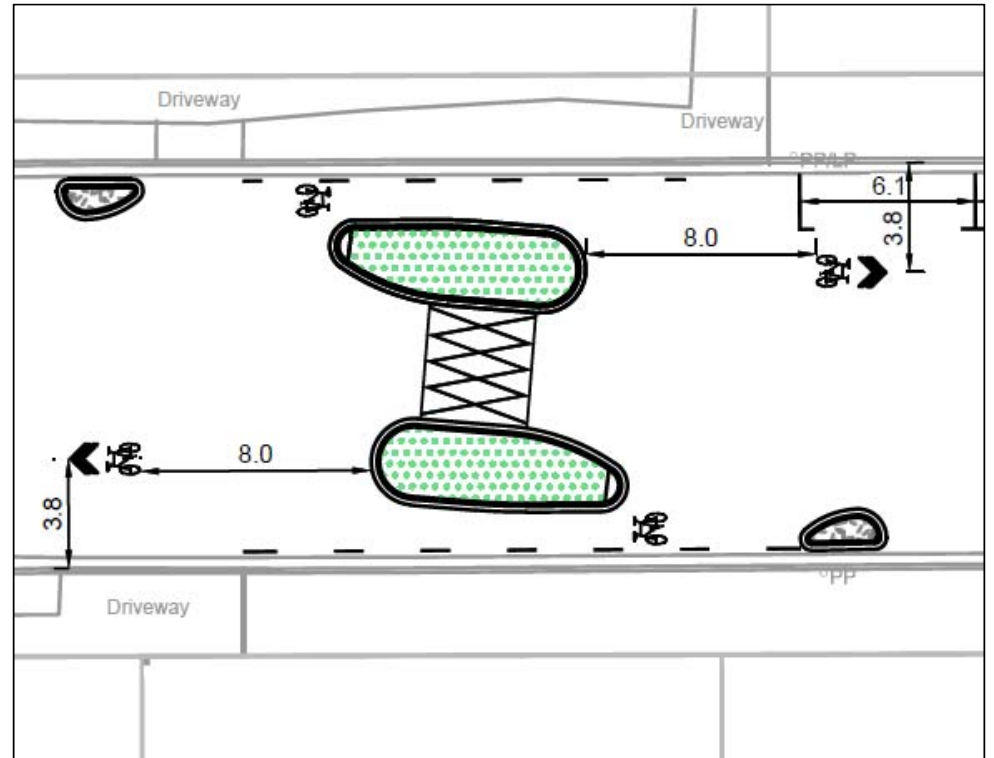
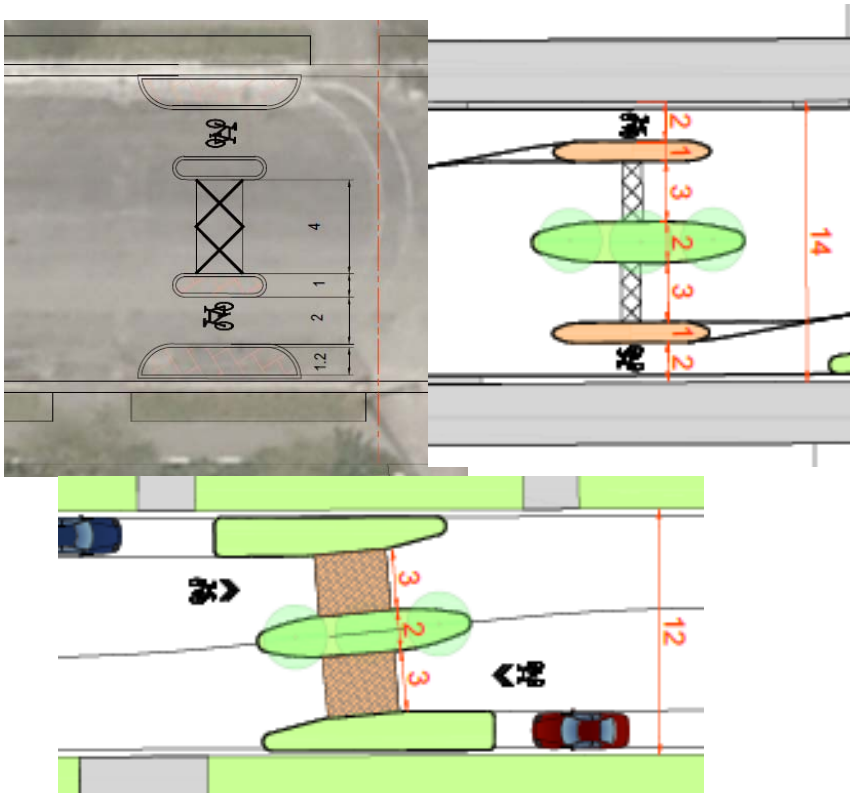



Rapanui (Shag Rock) Cycleway

Worlds Bumpiest Street

stuff

Christchurch's Worcester St now one of the world's bumpiest streets



ALDEN WILLIAMS/STUFF

Worcester St in east Christchurch is vying for the record for most speed bumps in a street.

Christchurch's Worcester St has been given a very bumpy makeover.

The street is part of the Rapanui-Shag Rock Cycleway, one of the Christchurch City Council's 13 new major cycle routes.

Within 800 metres, there are 10 speed bumps and humps – humps being a gentler, wider version of a speed bump.



Neighbourhood Greenways

Neighbourhood Greenway – Mid-Block Treatment Selection for existing streets

Low Volume Residential Street (<1,500vpd, posted speed 30km/hr, parking reduction)

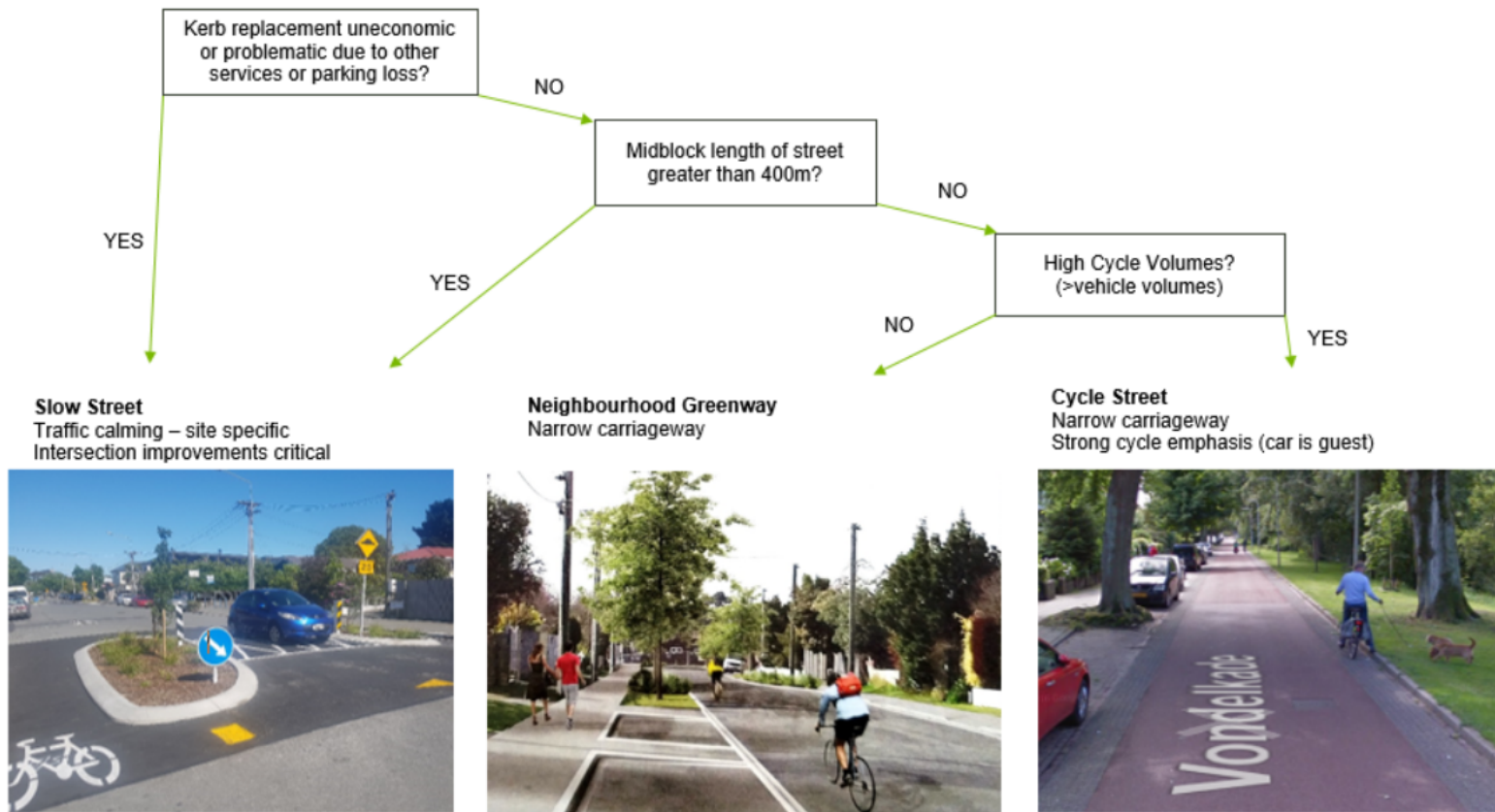

Neighbourhood Greenways

Cycle Street Threshold Sign

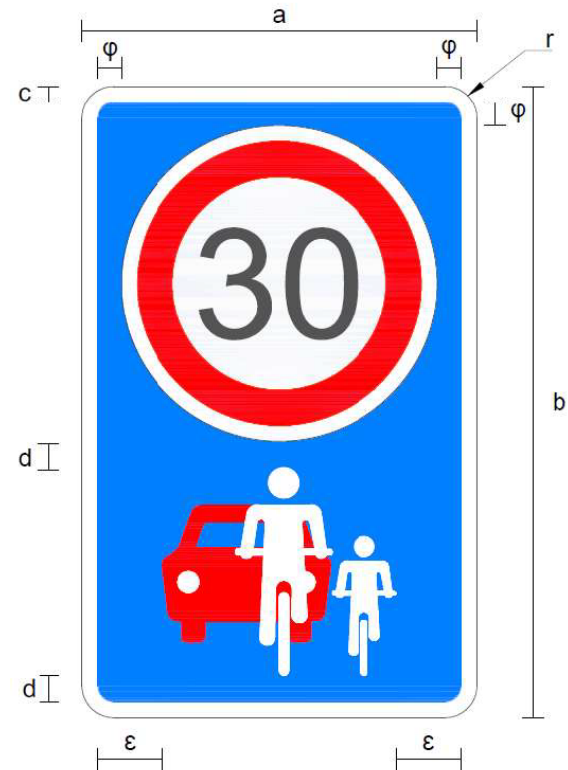



Rapanui (Shag Rock) Cycleway

Linwood Avenue

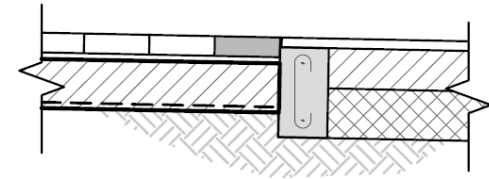

A
024 **PERMEABLE PATH
CONSTRUCTION**
NTS





Heathcote Expressway Route

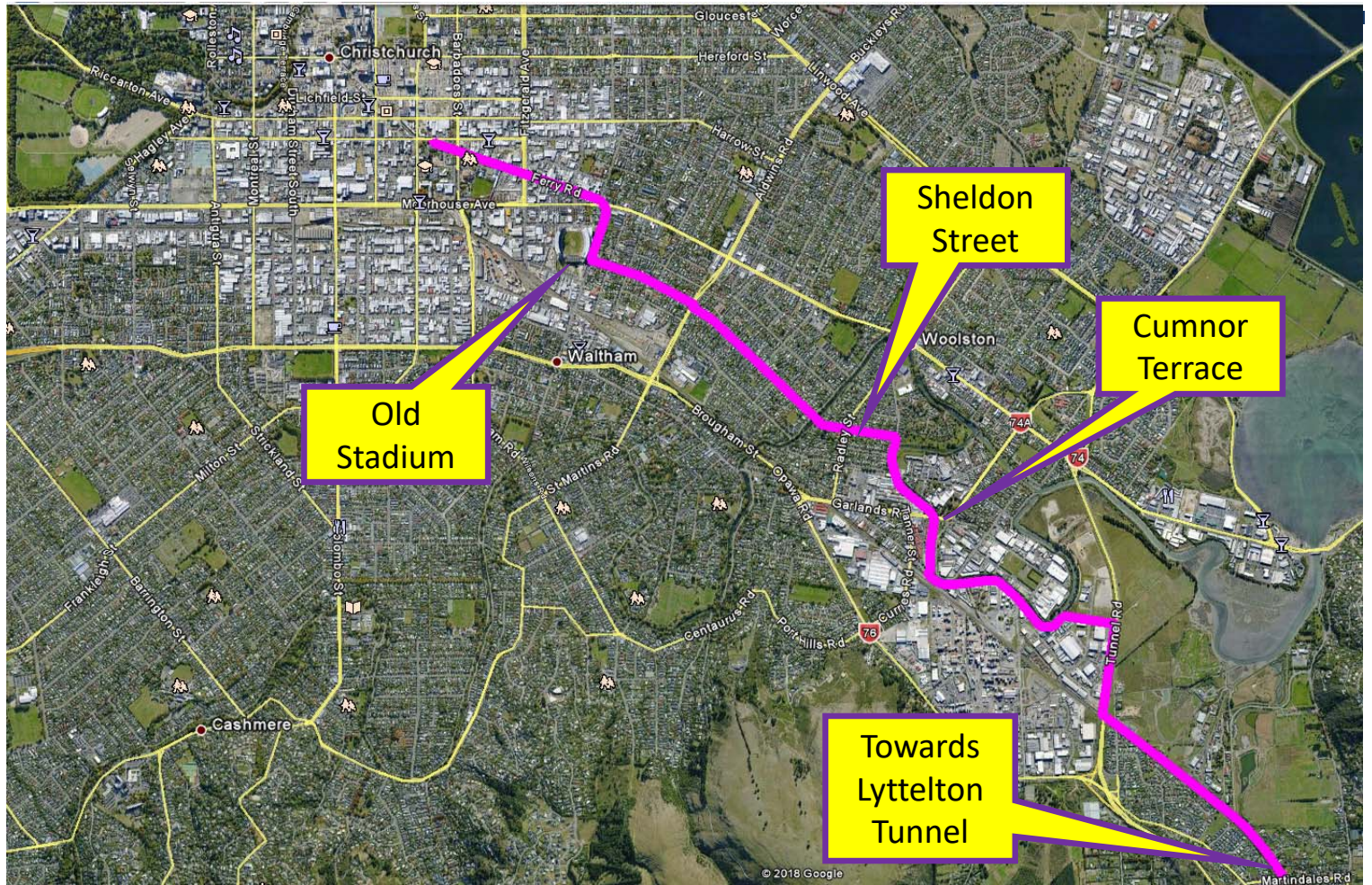

Old Stadium

Sheldon Street

Cumnor Terrace

Towards Lyttelton Tunnel

Heathcote Expressway Route

Sheldon Street

- Street Renewal
- Watermain replacement
- Public buy-in



BEFORE

VIEWPOINT 6 - MAJOR CYCLEWAYS - HEATHCOTE EXPRESSWAY - SHELDON STREET - LOOKING EAST



AFTER



Heathcote Expressway

Cumnor Terrace

- Industrial Zone
 - Currently Abandoned
 - Overflow Parking
 - Contaminated Ground
- Sensitive Ecology Area
 - Inanga Spawning
 - Desire to keep as much of existing river vegetation as possible



Heathcote Expressway Route

Cumnor Terrace – Proposed Solution = 1-Way Traffic

- 1-Way Traffic



- 2-Way Traffic





Uni-Cycle Route

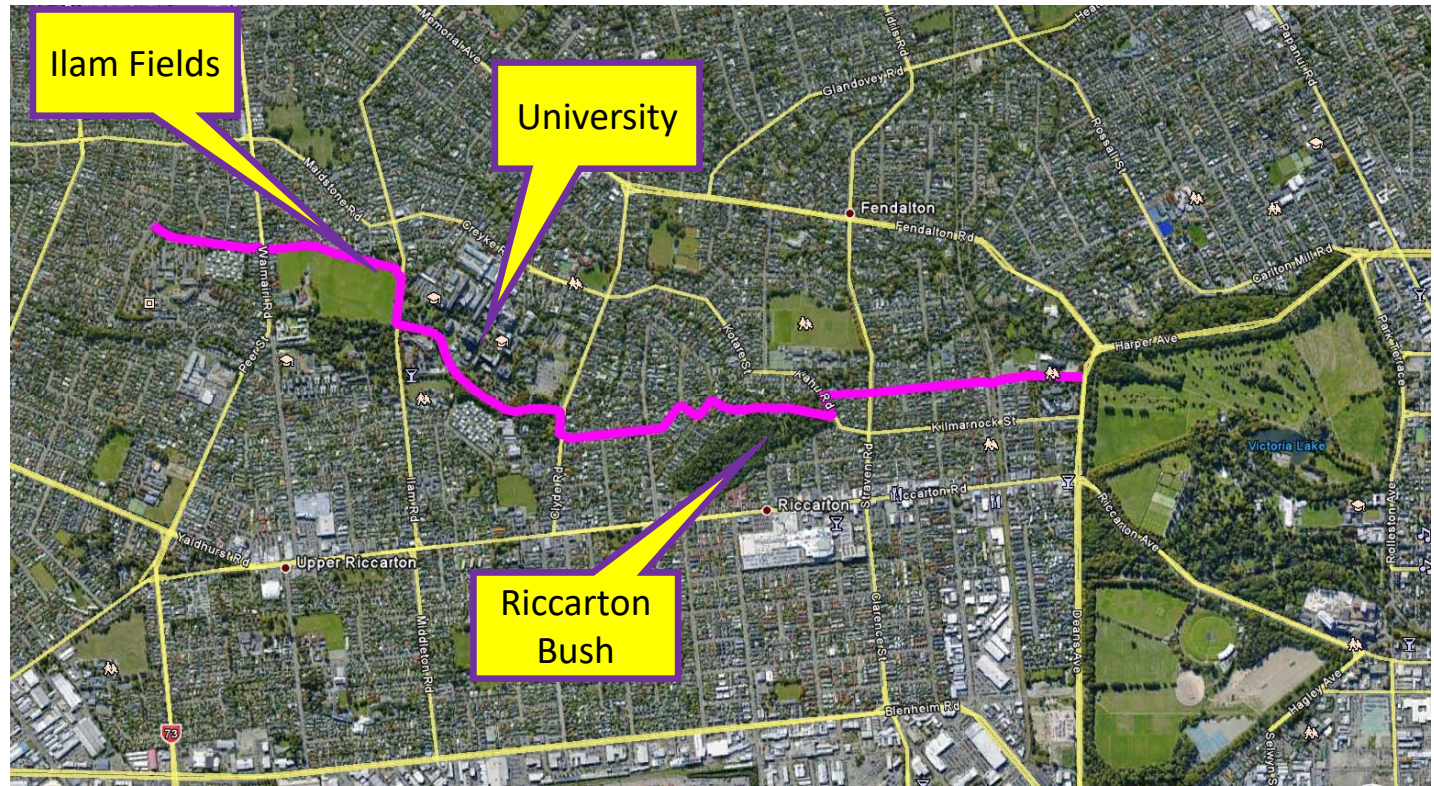



Uni-Cycle Route

Priority Crossings (Ilam Road)

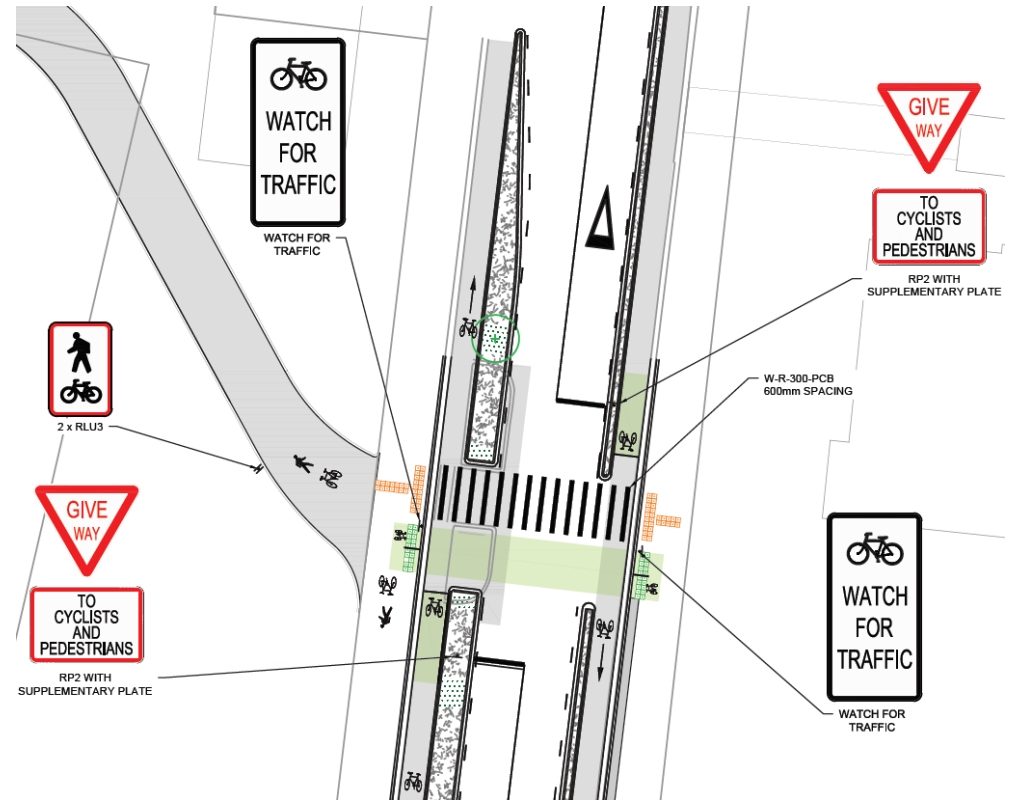



University Link Route

Ilam Road Chicane





Uni-Cycle Route

Riccarton Bush

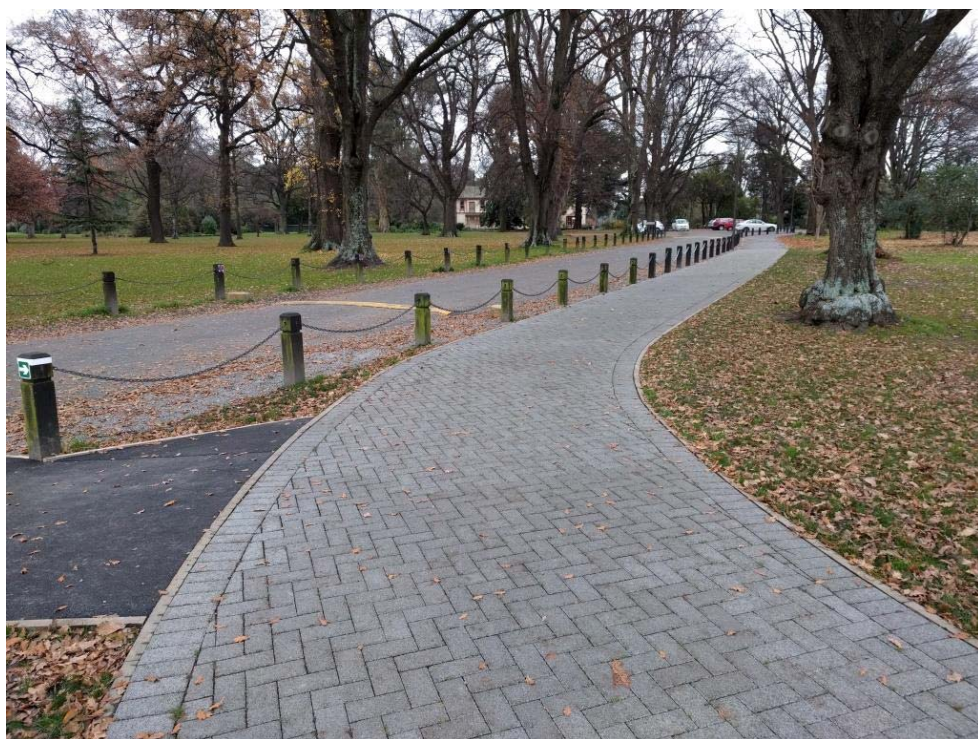



Thanks For Not Falling Asleep

Questions?

