

City of Launceston

Vulnerable Road User & Safer Rural Road Projects

City of Launceston

Vulnerable Road User & Safer Rural Road Projects

City of Launceston

Vulnerable Road User & Safer Rural Road Projects

- Project pool

City of Launceston

Vulnerable Road User & Safer Rural Road Projects

- Project pool
- Customer requests

City of Launceston

Vulnerable Road User & Safer Rural Road Projects

- Project pool
- Customer requests
- Risk assessment/iRap

City of Launceston

Vulnerable Road User & Safer Rural Road Projects

- Project pool
- Customer requests
- Risk assessment/iRap
- Safe System Assessment

Safe System Analysis – Westbury Road Pedestrian Refuge

| | |
|--|--|
| What is the reason for the project? | To enable pedestrians to cross Westbury Road safely to continue trips due to lack of a footpath north of Peel Street on the west side. |
| What is the function of the road? | Arterial |
| What is the speed environment? | 60 km/h. 7% gradient resulting in high speeds |
| What road users are present? | Mainly motor vehicles but pedestrians, including at times wheelchairs and prams, using the footpath. |
| What is the vehicle composition? | Around 11,000 vehicles per day. 3.2% heavy vehicles |

| | Run off road | Head on | Intersection | Other | Pedestrian | Cyclist | Motor cyclist | Total |
|-------------------|--------------|---------|--------------|-------|------------|---------|---------------|--------|
| Exposure | 3/4 | 3/4 | 2/4 | 3/4 | 2/4 | 1/4 | 1/4 | |
| Likelihood | 2/4 | 3/4 | 3/4 | 3/4 | 3/4 | 2/4 | 1/4 | |
| Severity | 2/4 | 2/4 | 2/4 | 2/4 | 4/4 | 4/4 | 4/4 | |
| Product | 12/64 | 18/64 | 12/64 | 18/64 | 24/64 | 8/64 | 4/64 | 96/448 |

City of Launceston

Vulnerable Road User & Safer Rural Road Projects

- Project pool
- Customer requests
- Risk assessment/iRap
- Safe System Assessment
- Contribution – general or dedicated budget?

City of Launceston

Vulnerable Road User & Safer Rural Road Projects

- Project pool
- Customer requests
- Risk assessment/iRap
- Safe System Assessment
- Contribution – general or dedicated budget?
- Projects on State Roads

City of Launceston

Vulnerable Road User & Safer Rural Road Projects

- Project pool
- Customer requests
- Risk assessment/iRap
- Safe System Assessment
- Contribution – general or dedicated budget?
- Projects on State Roads
- Application

City of Launceston

Vulnerable Road User & Safer Rural Road Projects

- Project pool
- Customer requests
- Risk assessment/iRap
- Safe System Assessment
- Contribution – general or dedicated budget?
- Projects on State Roads
- Application
- Grant Deed

City of Launceston

Vulnerable Road User Projects

2014

John Lees Drive Shared Path

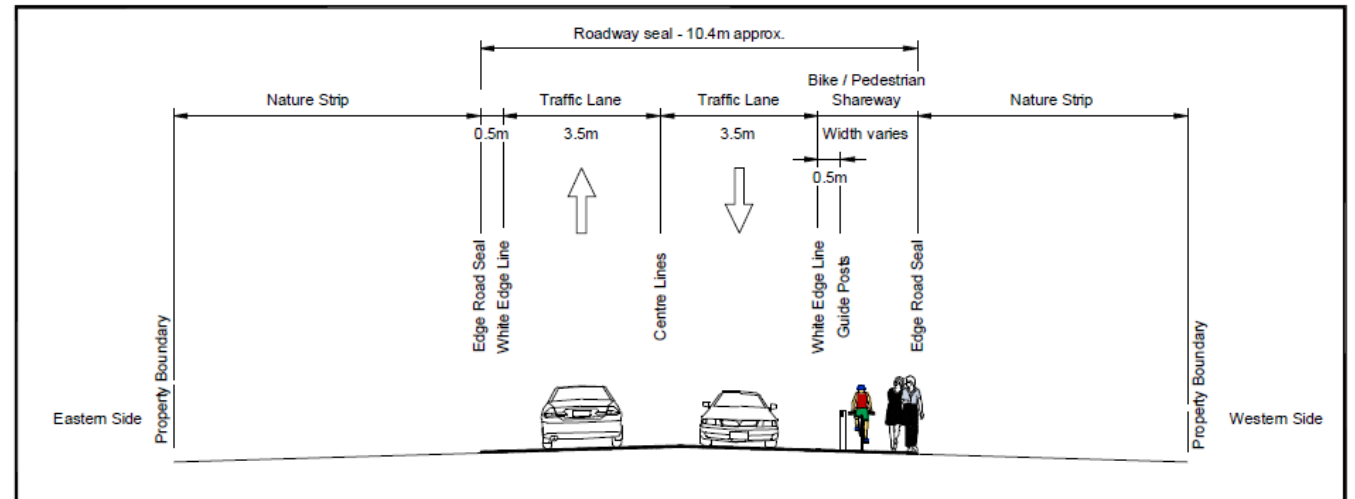

Total Cost \$106,000

2014

Tasman Highway/ Top Shop Pedestrian Refuge

Total Cost \$11,000



2015

Hobart Road Pedestrian Crossing

Total Cost \$150,000



2015

St Leonards
Road
Bike Lanes

Total Cost \$56,000



2015

Elphin Road Green Bike Lanes

Total Cost \$30,000



2016

Elphin Road Pedestrian Refuge



Total Cost \$30,000

2016

Lawson Street Pedestrian Refuge

Total Cost \$10,000

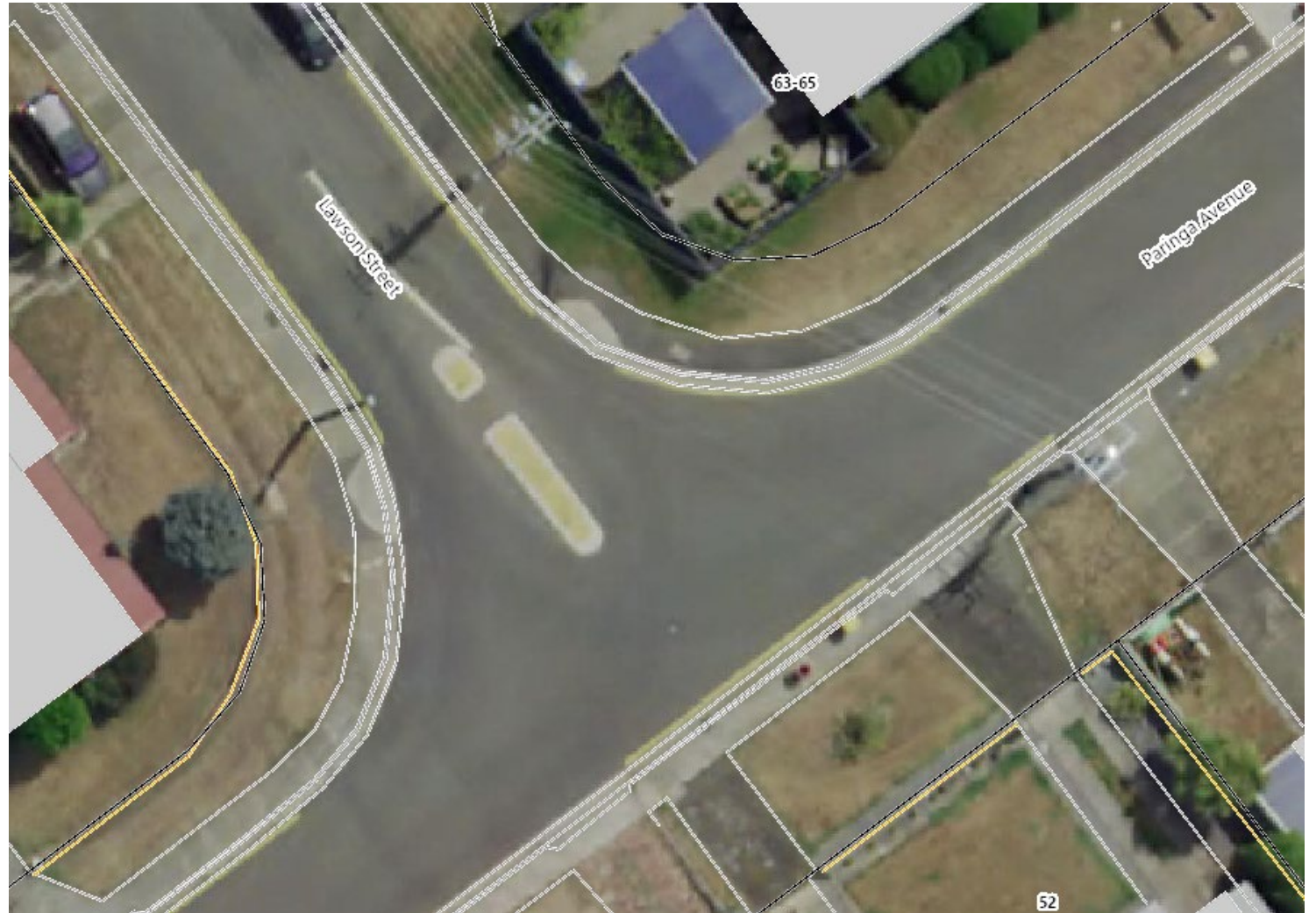

2017

Tamar Street/ Cameron Street Pedestrian Crossing

Total Cost \$20,000

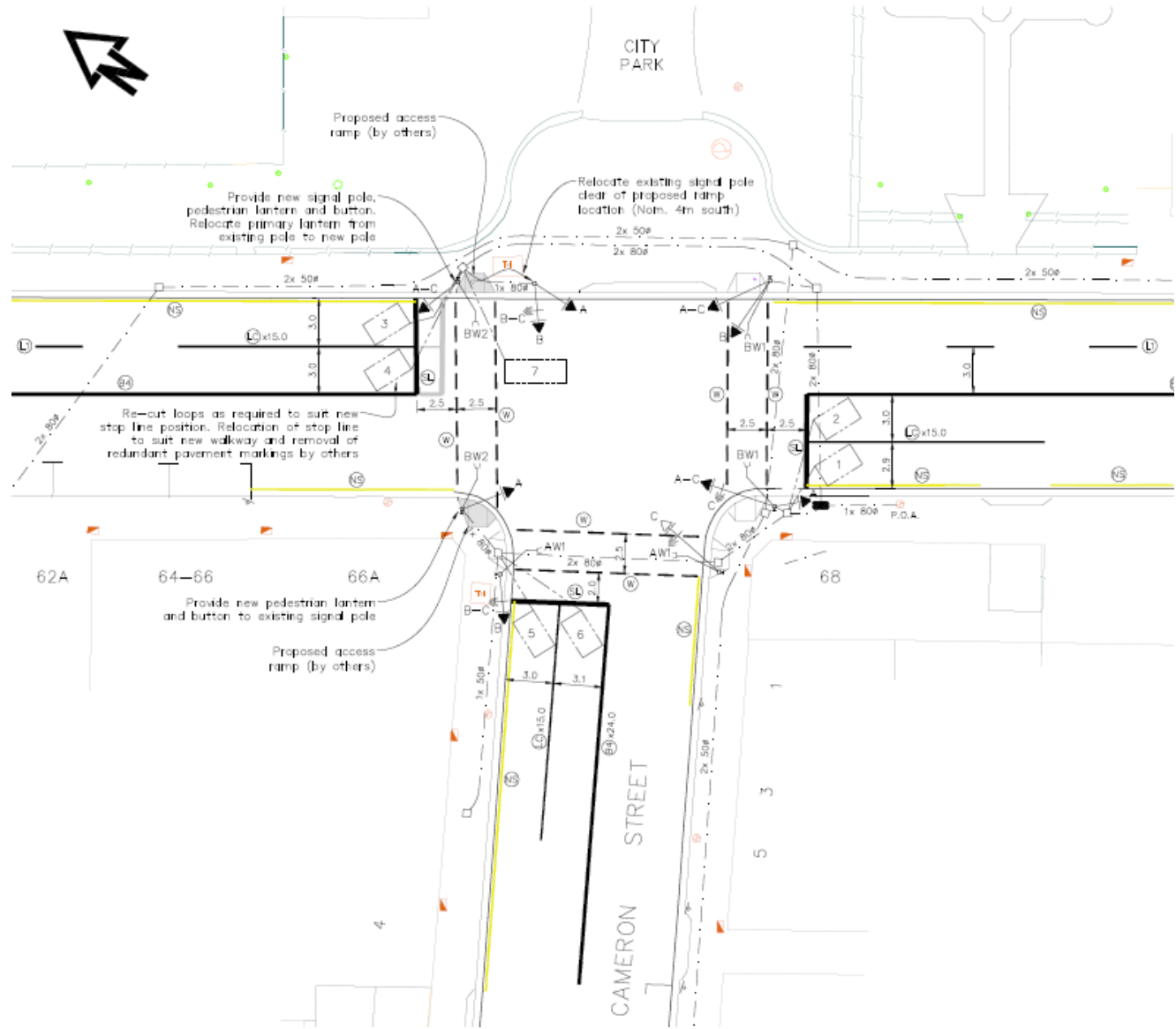

2018

Lyttleton Street/ Elphin Road Pedestrian Refuge

Total Cost \$35,000



2018

Dowling Street/ Elphin Road

Cyclists Protected
Left Turn

Total Cost \$31,000



2020

Wellington St/ Norwich Street Pedestrian Refuge

Total Cost \$72,000



2021

Westbury Road/
Peel Street
Pedestrian
Refuge

Total Cost \$120,000



2021

Opossum Road Electronic School Speed Signs

Total Cost \$17,000

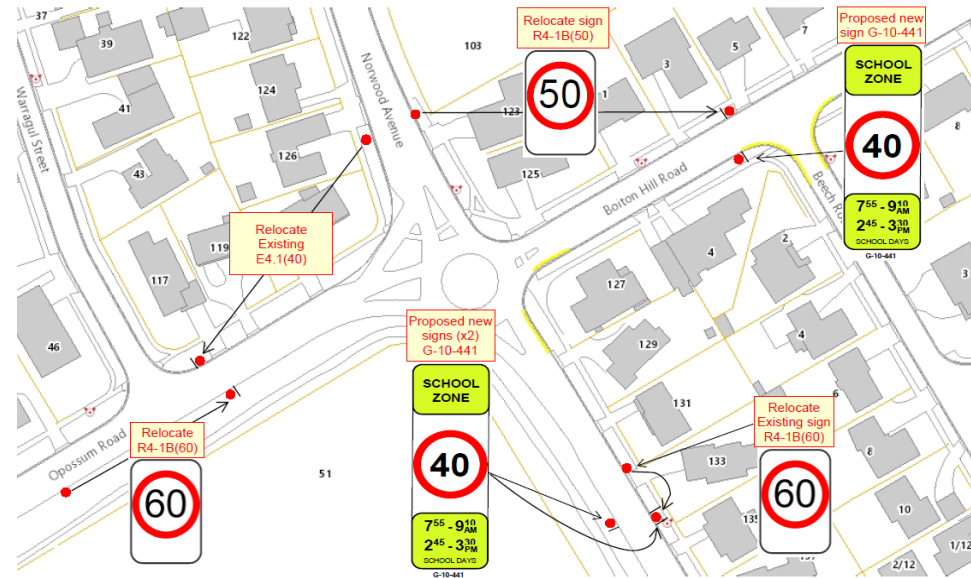

City of Launceston

Safer Rural Road Projects

2021

Glenwood Road

Line marking

Guideposts

Guardrail

Signage

Intersection upgrade

Total Cost \$140,000



2021

Relbia Road
Line marking
Guideposts
Guardrail
Signage

Total Cost \$56,000



2021

Lilydale Road
Line marking



Total Cost \$15,000

2021

Golconda Road
Line marking

Total Cost \$30,000



Local Government

Contribution to Road Safety

Local Government

Contribution to Road Safety

- Local knowledge
- Local community contact
- Primary responsibility, and duty of care, as a road authority
- Planning authority responsibility

Austrroads Guide to Road Safety Part 7

Local Government *Contribution to Road Safety*



Local Government

Contribution to Road Safety

'As a general observation, local government has limited capacity to address road safety issues without support from Federal and State governments (Woolley et al. 2018)'

Austrroads Guide to Road Safety Part 7

Local Government

Contribution to Road Safety

- Roads & Roadsides
- Speeds
- Road Users
- Vehicles



Local Government

Contribution to Road Safety

- Time
- Expertise
- Influence



Local Government

Contribution to Road Safety

- Roads & Roadsides



Local Government

Contribution to Road Safety

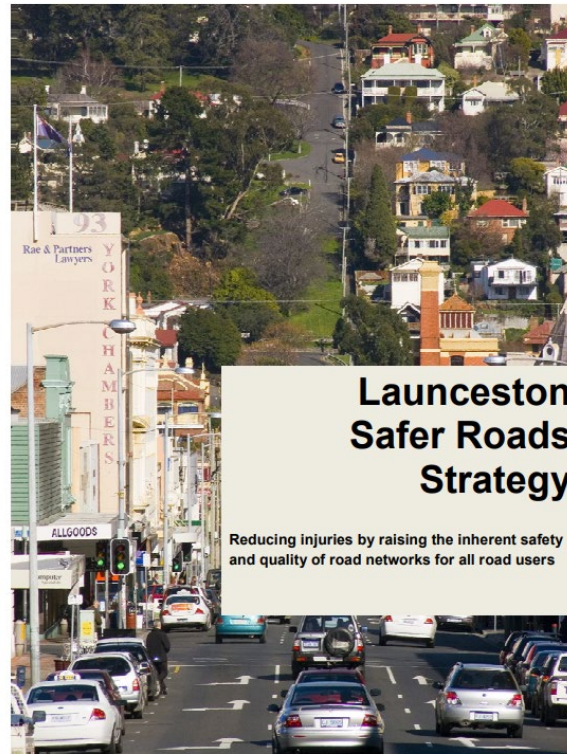

Local Government

Contribution to Road Safety



Local Government

Contribution to Road Safety

- Road Users



Local Government

Contribution to Road Safety



Cyclist Safety: Let's have each other's backs. We all have someone to get back to



Local Government

Contribution to Road Safety

- Vehicles



Local Government

Contribution to Road Safety

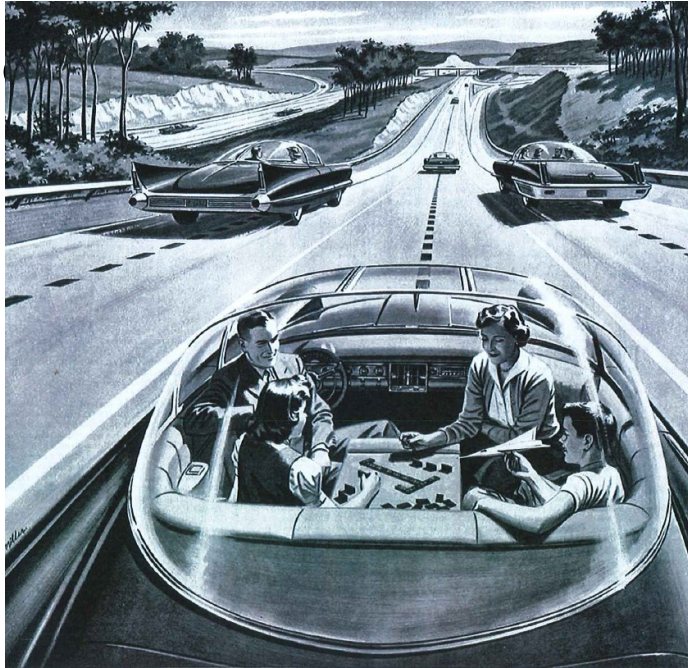

Thank you

Nigel Coates

City of Launceston

Nigel.Coates@Launceston.tas.gov.au

(03) 6323 3442