

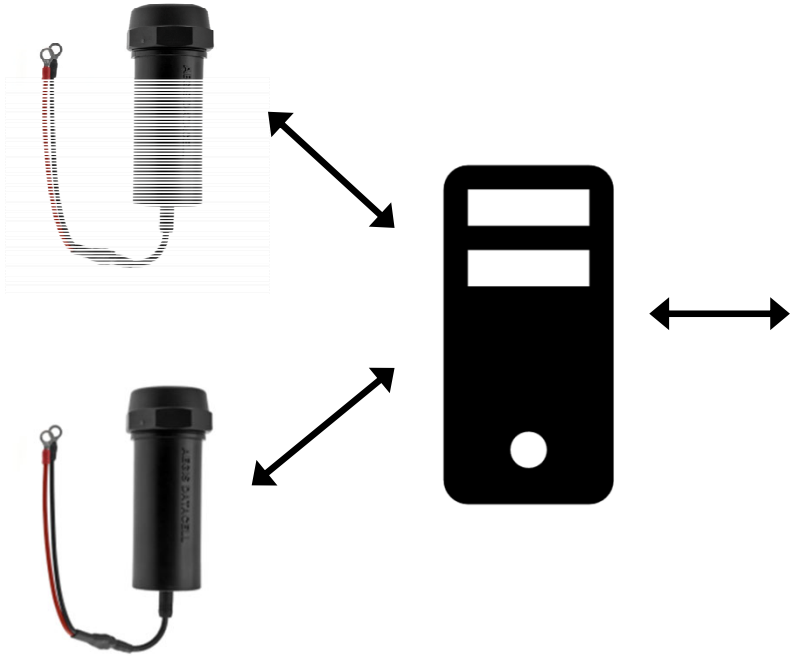

Datacell Remote Monitoring System



DataCell DATACELLCP Dashboard Settings Support

Aegis Demo

Total	Active	High Alarm	Low Alarm	High Rate	Low Rate
9	9	0	0	0	0

Map View Graph Reports

Search: tp

Name	Serial#	Site	Ch1 (24Hr)	Ch2 (24Hr)	Ch3 (24Hr)	Ch4 (24Hr)	Signal	Battery	Last Data	Alarm
TP.000	0311E010	pipeline a	-1230 mV	3.7938 Vac	1056.4 mV	-2857 mV	18%	87%	06-06-2022 12:00 am	🔴
TP.001	0311E011	Melb CP	-1216 mV	5.668 Vac	-1253 mV	-1345 mV	62%	81%	06-06-2022 12:00 am	🔴
TP.002	0311E012	Melb CP	-1203 mV	7.6128 Vac	-1161 mV	-1251 mV	79%	82%	06-06-2022 12:00 am	🔴
TP.003	0311E013	Melb CP	-1187 mV	1.9035 A	-1147 mV	-1234 mV	72%	84%	06-06-2022 12:00 am	🔴
TP.004	0311E014	pipeline a	-1173 mV	1.8999 A	-1132 mV	-1219 mV	74%	83%	06-06-2022 12:00 am	🔴
TP.005	0311E015	Melb CP	-1149 mV	1.8971 A	-1102 mV	-1199 mV	89%	81%	06-06-2022 12:00 am	🔴



Background

- 2007 Aegis develops monitoring system for Pipeline Assets
- Australian designed, manufactured and supported
- Mass deployed on Impressed Current Cathodic Protection
- Validates the integrity of the Cathodic Protection
- 3G/4G/IoT Communication
- Enables automatic pipeline monitoring
- Remotely controlled pipeline surveys



Problems for regional deployment

- Remote location reliability
 - Due to poor communication
 - Harsh environments
- Costs of existing solutions
 - Expensive product
 - Complex installation
 - Expensive on-going remote communications

Due to these constraints - Sites Manually serviced

- Cost
 - Time to access – personnel hours
 - Vehicle hours
- Safety
 - Driving long distances
 - Test point site accessibility





Datacell S2 Solution

Datacell S2 Test Point Logger 2022

- Low-cost product & satellite communication
- Up to 10 Years maintenance free
- Simple installation
- Battery powered – no other power source required
- 100% regional coverage
- 2 Way communication - remotely configurable

Advantages

- Reduced costs
 - Man & Vehicle hours
- Increased Safety
 - Reduce hours travelling
 - Remote location dangers
- Increased knowledge
 - 24/7 Asset visibility
 - \approx 5000 measurements / year

